

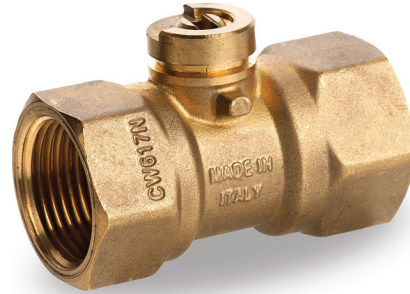

s.31 NPT Mini Valve

1/4" - 3/4"

This newly engineered valve features all the good characteristics of the s.31 **RuB** mini valve, in particular:



Quality:

- 100% seal test guaranteed in according to EN12266-1 RATE A in either direction
- Compatible with most industrial fluids including those too viscous for pilot operated valves
- Dual sealing system allows valve to be operated in either direction making installation easier
- No metal-to-metal moving parts
- No maintenance ever required
- Silicone-free lubricant
- Chrome plated ball for longer life
- Can operate also in vacuum line

Body:

- Finest brass according to EN 12165 and EN 12164 specifications
- Strong one piece body construction

Stem:

- Blowout-proof brass stem
- Double FPM O-rings at the stem for maximum safety

Sealing:

- Pure PTFE self-lubricating seats

Threads:

- NPT taper ANSI B.1.20.1 threads

Working pressure and temperature:

- Shell rating: 600 PSI non-shocking cold working pressure
- Seat rating: Delta P max permissible 230 PSI
- -4°F to +250°F
- **WARNING:** freezing of the fluid in the installation may severely damage the valve

Options:

- ISO 7/1, BS 21 BSPT taper threads
- EN 10226-1, ISO 228 parallel female by female threads

PED directive:

- The product meets the requirements of PED Directive 2014/68/UE and according to art.4 par.3, it does not require CE marking

Approved by or in compliance with:

- RoHS Compliant (EU)

NOTE: approvals apply to specific configurations/sizes only.

Quick Connection with CP actuators



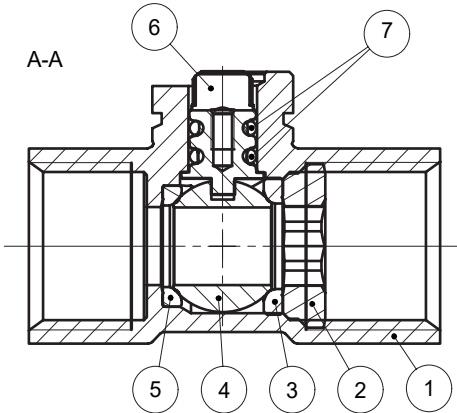

	Part description	Qty	Material
1	Sand blasted unplated NPT body	1	CW617N
2	Unplated retainer nut	1	CW617N
3	Retainer seat	1	PTFE
4	Chrome plated ball	1	CW617N
5	Body seat	1	PTFE
6	Unplated stem O-Ring design	1	CW617N
7	O-Ring	2	FPM

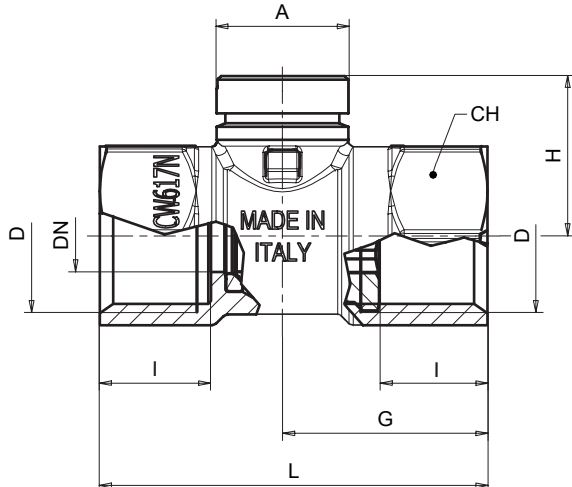

Code	AV31BX3	AV31CX3	AV31DX3	AV31EX3
D (inch)	1/4"	3/8"	1/2"	3/4"
DN (inch)	0.31	0.39	0.39	0.5
I (inch)	0.47	0.47	0.61	0.67
L (inch)	1.79	1.79	2.11	2.42
G (inch)	0.94	0.94	1.10	1.28
A (inch)	0.73	0.73	0.73	0.73
H (inch)	0.89	0.89	0.89	1.00
CH (inch)	0.98	0.98	0.98	1.22

Torque for actuator sizing in-lb

Delta P -->	0 - 230 PSI
Valve size	in-lb
1/4" - 1/2"	16
3/4"	22

Torque correction factors

Valve torque can vary according to operating frequency, temperature and friction characteristics of the media.
 If media has more or less friction than water, multiply torque by the following factors:

Lubricating oils or liquids	0.8
Dry gases, natural gas	1.5
Slurries or liquids bearing abrasive particles	1.5 to 2.5

Pressure-temperature chart

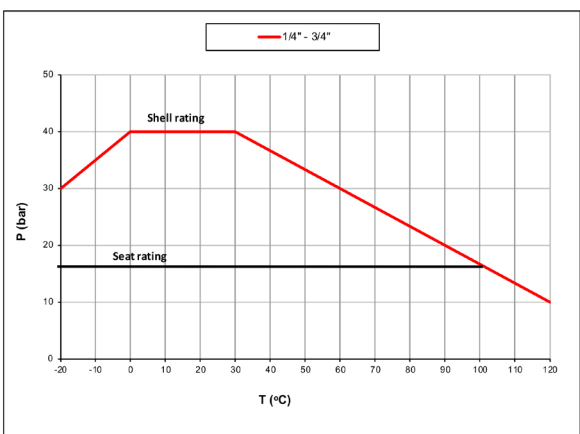

Pressure drop chart

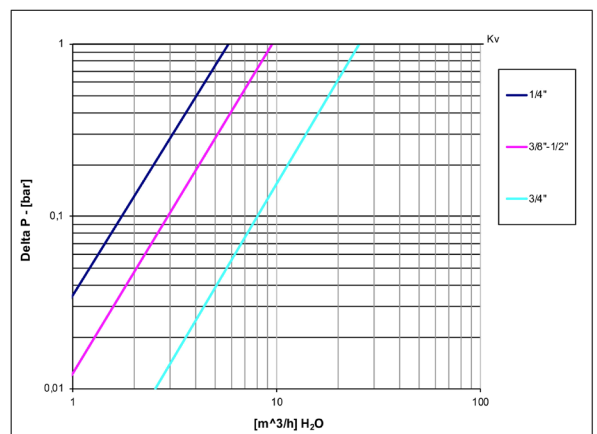

WARNING: This product can expose you to chemicals including lead which is known to the state of California to cause cancer and birth defects or other reproductive harm. For more information go to www.P65Warnings.ca.gov